

Quotation No. Q2577-C



**LIBRARY INTERIORS OF TEXAS, LLC**  
 3503 Wild Cherry Drive Building 4  
 Lakeway, TX 78738  
 P: 888-689-5489 (LITX)  
 F: 888-690-5489 (LITX)

Library Interiors - TX Project ID: Q2577-C

Issued By: Dee Steele | delmaris@li-tx.com

Date: 3/26/2021

**Bill-to:** Wells Branch Community Library  
 15001 Wells Port Dr  
 Austin, TX 78728

**Ship-to:** Wells Branch Community Library  
 15001 Wells Port Dr  
 Austin, TX 78728

Terms **Net 30 Days**

**Contact:** Donita Ward  
**Phone:** 512-989-3188

**Contact:** Donita Ward  
**Phone:** 512-989-3188

Item #	Colors/Finishes	Quantity	Part#	Description	Unit List	Ext List	Disc	Unit Net	Ext Net
<b>Welcome Station Desk</b>									
Item 1	Top: Marmoleum Fresco Eternity 3866 PVC: Rehau Castle Oak CP20580 HPL Front/Sides: WA Castle Oak 7928-38 Powder Coat: 809 Silver	1	ND-84DL-MOB-WHP	Media Technologies Nomad Desk,TRX top Left, 30"D x 84" W x29"/35"H,Mobile w/ Hanging Pedestal & Box & File Drawer-809 Silver To Include Cable Channel Management	10,379.00	10,379.00	43%	5,916.03	5,916.03
<b>T2 Design: Circulation Desk, Storage Unit, Desk Book Drop, End Panels</b>									
Item 2	Top: Marmoleum Fresco Eternity 3866 PVC: Black to Match Existing Oak Veneer Stained to Match Existing	1	T2.CUSTOM	T2 Design - Custom 2-Module Crescent Information Desk with Back Counter	28,938.78	28,938.78	30%	20,257.14	20,257.14
Item 3	TBD Standard HPL	1	T2.CUSTOM	T2 Design - Custom Built-In Book Drop with Mobile Bin and Vinyl Lettering	1,204.08	1,204.08	30%	842.86	842.86
Item 4	TBD Standard HPL	3	T2.CUSTOM	T2 Design Self-Edge Laminate End Panel, 84"H x 25"W	500.00	1,500.00	30%	350.00	1,050.00
								Product Total:	28,066.03
								Freight and Installation:	4,490.56
								Total FF&E:	32,556.59
<b>Demo &amp; Supply of New Flooring, Demo of Existing Desks, Shelving Relocation</b>									
Item 5	Archaic Forms-GT321 Color Balance:TBD (optic, tropic, aquarius, filtered electric)	1	T2GT321	T2 Design - Mohawk Archaic Forms Carpet Tile includes attic stock	60,744.46	60,744.46	net	60,744.46	60,744.46
Item 6	N/A	1	N/A	Demolition and Removal of Existing Floor Covering & Installation of All New Carpet Tiles	27,857.14	27,857.14	net	27,857.14	27,857.14



Library Interiors of Texas, LLC. standard terms and conditions of sale apply.



**Quotation No. Q2577-C**

Item 7	N/A	1	N/A	Book & Furniture/Shelving Move	55,500.00	55,500.00	net	55,500.00	55,500.00
Item 8	N/A	1	N/A	Demolition & Removal of Existing Circulation & Information Desks	5,000.00	5,000.00	net	5,000.00	5,000.00
Item 9	N/A	1	N/A	Electrical Contingency	3,000.00	3,000.00	net	3,000.00	3,000.00

Construction/Move Total: \$ 144,101.60

<b>Project Total:</b>	176,658.19
<b>Contingency Fee:</b>	17,665.82
<b>Grand Total:</b>	<b>\$ 194,324.01</b>

- PROPOSAL INCLUDES DELIVERY AND INSTALLATION OF CARPET AND DEMO OF EXISTING CARPET
- RUBBER BASE SUPPLY AND INSTALLATION IS INCLUDED
- 10 BAGS OF FLOOR PREP ARE INCLUDED. IF MORE BAGS ARE NEEDED THEY WILL BE BILLED AT \$45/BAG.
- AFTERHOURS LABOR, AND DUMPSTER FEES ARE NOT INCLUDED.
- ALL WORK TO BE PERFORMED DURING NORMAL HOURS OF BUSINESS UNLESS NOTED OTHERWISE
- ONLY MINOR FLOOR PREP IS INCLUDED
- THE FILING OF HOLES, TRENCHES, AND MAJOR FLOOR LEVELING IS NOT INCLUDED UNLESS NOTED OTHERWISE
- CLEANING, WAXING, VACUUMING OR PROTECTION OF NEW FLOOR IS NOT INCLUDED UNLESS OTHERWISE NOTED
- EXCLUDES MOISTUE SUPPRESSION SYSTEM





CLIENT  
Wells Branch Community Library

ISSUE  
3.1.2021

PROJECT NO.  
D2577 V2  
PROJECT  
Phase 1

DRAWN BY  
PF



T2 DESIGN

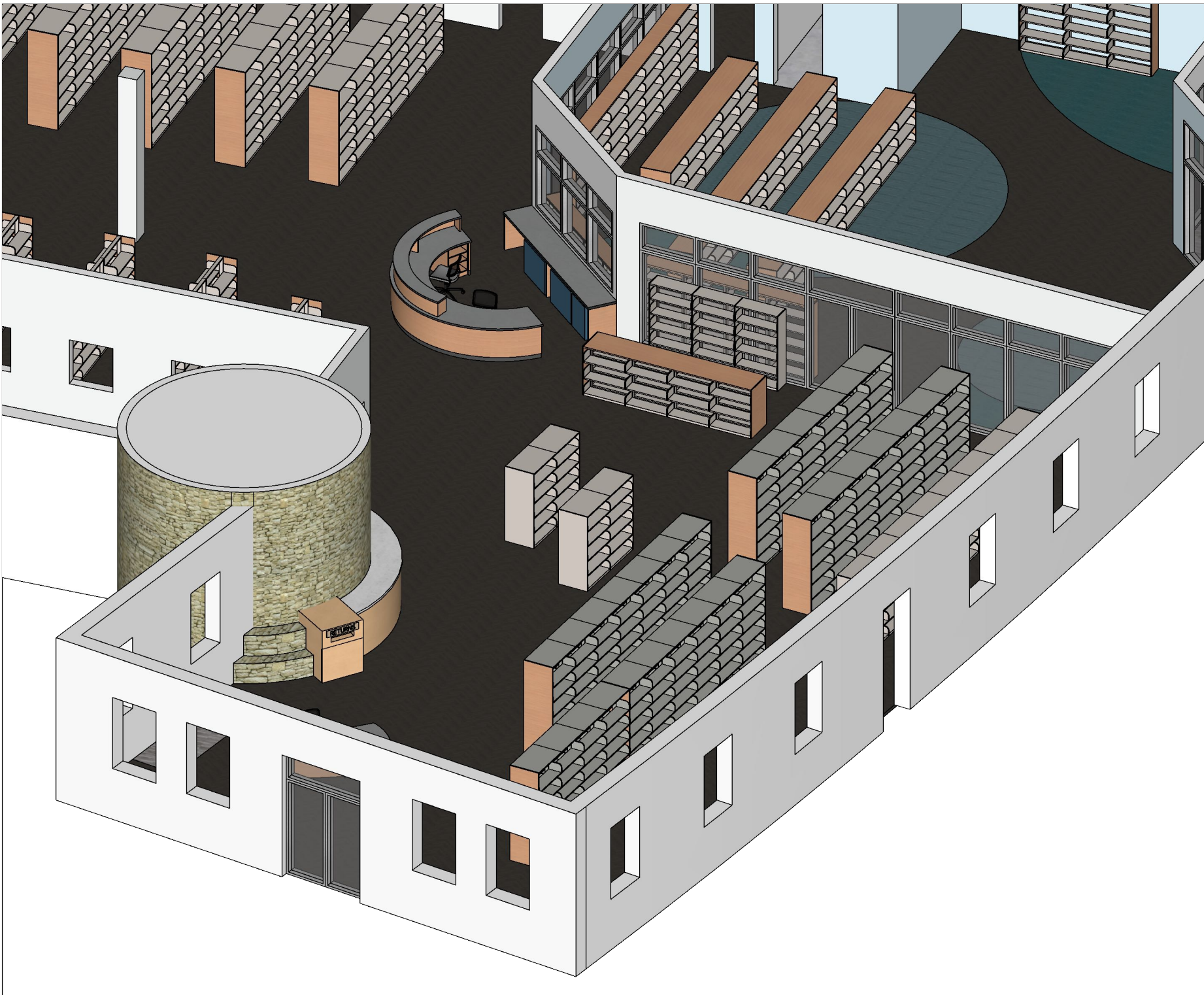

CLIENT  
Wells Branch Community Library

ISSUE  
3.1.2021

PROJECT NO.  
D2577 V2  
PROJECT  
Phase 1

DRAWN BY  
PF



T2 DESIGN

# Product Details



Product: Color Balance  
Color: 556  
Size: 12" x 36"  
Installation: Random



Product: Color Balance  
Color: 655  
Size: 12" x 36"  
Installation: Random



Collection: Altered States  
Product: Archaic Forms  
Color: 979  
Size: 12" x 36"  
Installation: Random



Patterns and colors shown are for visual representation only and are not ready for production purposes. Quantities shown are not to replace estimations.

**Project Name:** Wells Branch Library  
**Job#:** 141822 / 42981

**Date:** 03/11/21 LT  
**Revision:** R3 **Page:** 01



Product Details



Product: Color Balance  
Color: 556  
Size: 12" x 36"  
Installation: Random



Product: Color Balance  
Color: 655  
Size: 12" x 36"  
Installation: Random



Collection: Altered States  
Product: Archaic Forms  
Color: 979  
Size: 12" x 36"  
Installation: Random

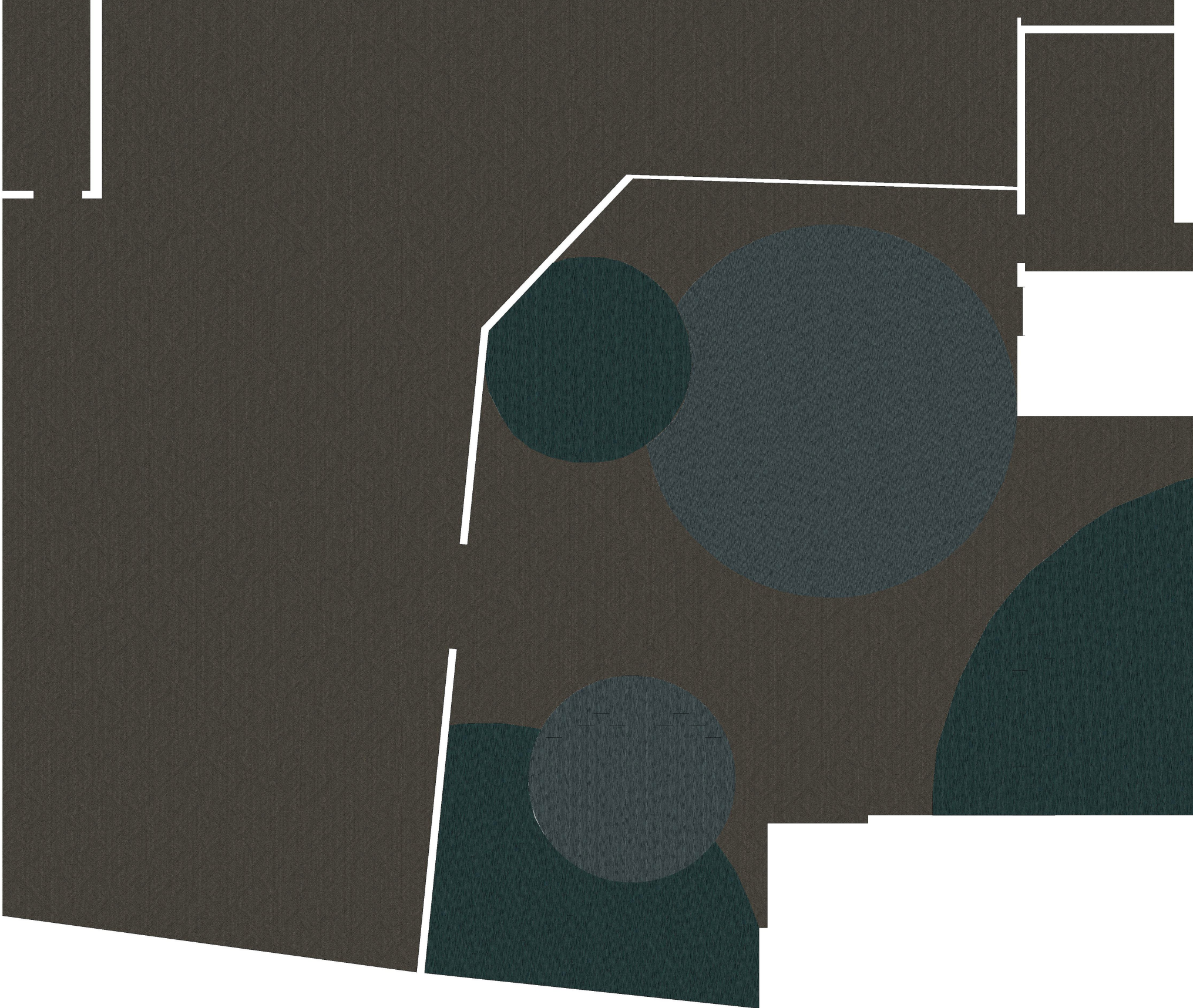

Close Up



Patterns and colors shown are for visual representation only and are not ready for production purposes. Quantities shown are not to replace estimations.

**Project Name:** Wells Branch Library  
**Job#:** 141822 / 42981

**Date:** 03/11/21 LT  
**Revision:** R3 **Page:** 02



# Product Details

 Product: Color Balance  
 Color: 556  
 Size: 12" x 36"  
 Installation: Random

 Product: Color Balance  
 Color: 655  
 Size: 12" x 36"  
 Installation: Random

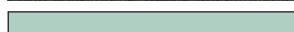
 Collection: Altered States  
 Product: Archaic Forms  
 Color: 979  
 Size: 12" x 36"  
 Installation: Random

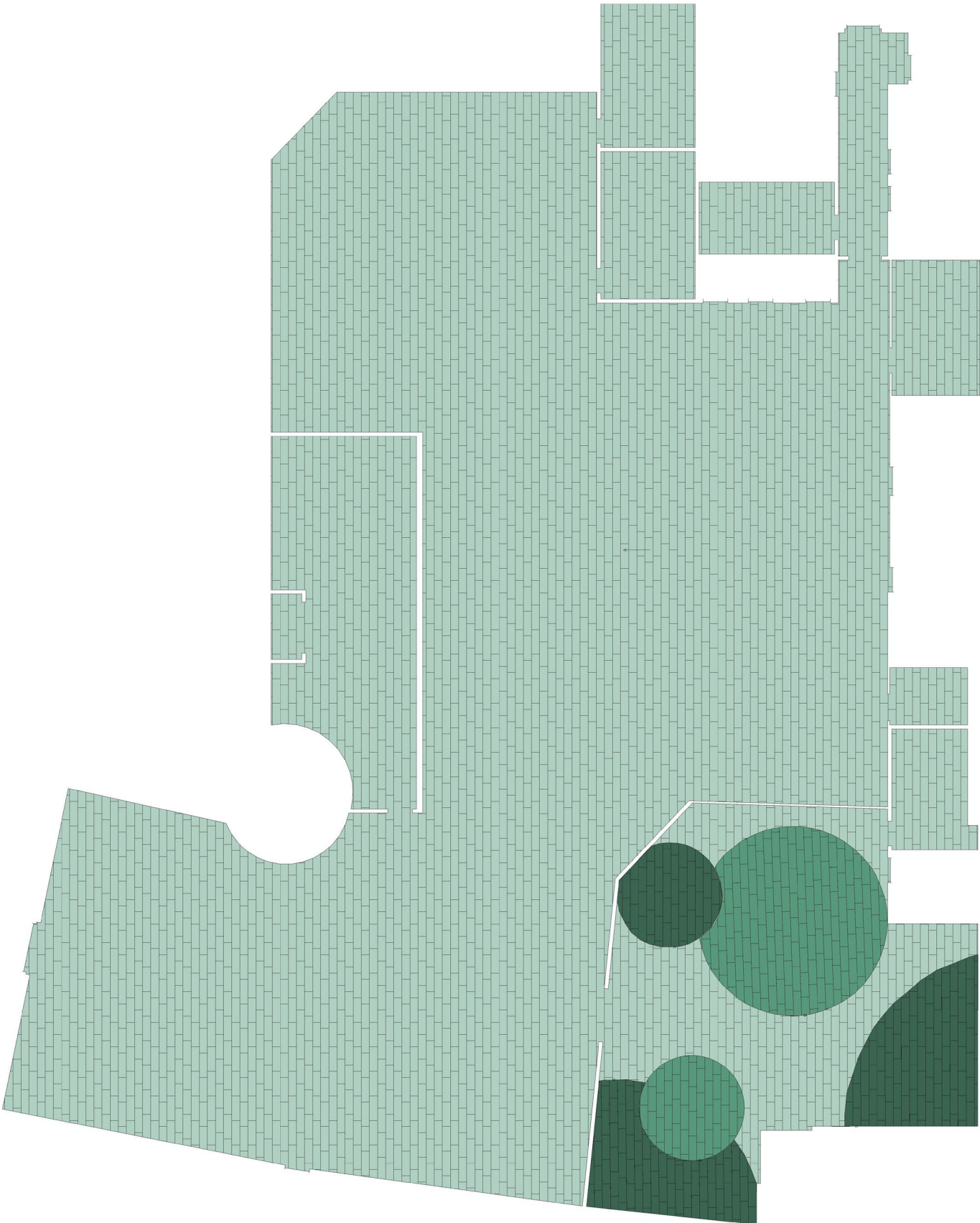

## Install Guide

Patterns and colors shown are for visual representation only and are not ready for production purposes. Quantities shown are not to replace estimations.

**Project Name:** Wells Branch Library  
**Job#:** 141822 / 42981

**Date:** 03/11/21 LT  
**Revision:** R3 **Page:** 03



## LIBRARY INTERIORS OF TEXAS, LLC - TERMS AND CONDITIONS OF SALE

Please read these terms and conditions carefully. All orders for goods and any related services ("Products") by any buyer ("you") from Library Interiors of Texas, LLC ("LI-TX") are governed by these terms and conditions.

- 1. Exclusive Terms.** LI-TX AGREES TO SELL ITS PRODUCTS ONLY ON THESE TERMS AND CONDITIONS. LI-TX EXPRESSLY OBJECTS TO ANY ADDITIONAL OR DIFFERENT TERMS IN YOUR PURCHASE ORDER OR SIMILAR DOCUMENT. No action by LI-TX shall be construed as an acceptance of any additional or different terms. You shall be deemed to have accepted these terms and conditions by any written indication of acceptance, by submitting an order in response to a quotation, by any action affirming your order without objection to these terms and conditions, by accepting any whole or partial shipment of Products, or by making any whole or partial payment to LI-TX.
- 2. Price.** Unless LI-TX agrees otherwise in writing, you agree to pay LI-TX's price in effect at the time an order is accepted by LI-TX for all products and services ordered. Prices do not include freight, insurance, installation, export fees, storage, duties, or sales, use, or excise taxes, any special processing, handling, packaging, or other special treatment, or any other charges, fees, or taxes, all of which are your responsibility; provided, however, that the price shall include ocean freight, duties, and other costs incurred, if any, to bring the Products to the United States. LI-TX reserves the right, by giving you notice at any time before delivery, to increase the price of the Products to reflect any increase in the manufacturing or production cost to LI-TX, any change to delivery dates, quantities or specifications for the Products requested by you, or any delay caused by your instructions or your failure to give LI-TX adequate information or instructions.
- 3. Cancellation of Orders.** You may not cancel an order, in whole or in part, without the written consent of LI-TX. No cancellation will be accepted by LI-TX except on terms that will fully indemnify and reimburse LI-TX against loss, including recovery of all costs incurred by LI-TX, and including indirect and overhead charges and profit.
- 4. Delivery.** You acknowledge that shipment dates and delivery dates are estimates only. LI-TX agrees to use reasonable efforts to meet the estimated shipping date subject to your prompt provision of all necessary specifications and information; however, LI-TX will not be held responsible for any failure to meet an estimated date. If you request a delay in shipment, LI-TX shall have the right to (i) bill you for the Products at the initial requested delivery date, and (ii) bill you for any storage charges incurred. In the case of delivery of Products by installments, you agree that you will not treat the delivery of faulty Products in any one installment or the late delivery or non-delivery of any one installment as a repudiation of the whole contract. Unless special shipping instructions are received and accepted by LI-TX before the shipment date, LI-TX shall, in its sole judgment, determine the means and routing of shipment, or store the Products at your expense until you provide shipping instructions.
- 5. Risk and Title to Products.** Unless otherwise expressly agreed by LI-TX, all shipments are F.O.B. point of shipment. "Point of shipment" shall be, as applicable: LI-TX's dock; for drop shipments, manufacturer's or distributor's dock; for international Products, the United States point of entry. LI-TX will select the origin of all shipments, and all delivery destinations will be subject to LI-TX's approval. Title to and risk of loss for Products will pass at the F.O.B. point.
- 6. Exclusion of Warranties.** You acknowledge that LI-TX is not the manufacturer of the Products, and therefore (a) LI-TX MAKES NO EXPRESS OR IMPLIED WARRANTIES OF ANY KIND WITH RESPECT TO THE PRODUCTS, and (b) LI-TX EXPRESSLY DISCLAIMS ANY IMPLIED WARRANTY OF MERCHANTABILITY OR FITNESS FOR A PARTICULAR PURPOSE. All Products are warranted only to the extent of the manufacturer's warranties, which LI-TX will provide to you at your request.
- 7. Limitation of Remedies and Damages.** LI-TX's liability and your remedies under this Agreement will be limited solely to replacement or credit, at LI-TX's option, with respect to Products for which LI-TX has received, within thirty (30) days after your receipt of the Products, evidence satisfactory to LI-TX of defective or incorrect Products. LI-TX'S LIABILITY WILL IN NO EVENT BE GREATER IN AMOUNT THAN THE PURCHASE PRICE OF THE PRODUCTS. LI-TX WILL NOT BE LIABLE, UNDER ANY CIRCUMSTANCE, FOR CONSEQUENTIAL, INCIDENTAL, SPECIAL, OR PUNITIVE DAMAGES, INCLUDING, BUT NOT LIMITED TO, LABOR COSTS OR LOST PROFITS RESULTING FROM THE USE OF OR INABILITY TO USE THE PRODUCTS OR FROM THE PRODUCTS BEING INCORPORATED IN OR BECOMING A COMPONENT OF ANY OTHER ARTICLE. NEITHER PARTY WILL HAVE ANY NEGLIGENCE OR OTHER TORT LIABILITY TO THE OTHER, OR TO ANY THIRD PARTY, ARISING FROM ANY BREACH OF THIS AGREEMENT.
- 8. Variations.** Any minor shortages or defects that do not materially affect the use for which the Products are intended will not affect the terms of payment. Products, specifications, and colors may differ slightly from those illustrated in LI-TX's literature and samples. Any typographical or clerical omission in any sales literature, price list, quotation, acceptance of offer, invoice or other document or other information issued by LI-TX shall be subject to correction without any liability on the part of LI-TX.

**9. Claims.** LI-TX's responsibility for shipment shall cease upon delivery to the carrier. Any claims for damages or loss occurring in shipment shall be made by you directly to the carrier. All other claims for damages, defects, loss, shortages, or incorrect Products must be made within fourteen (14) days after receipt of the Products, unless otherwise agreed by the parties in writing. YOUR FAILURE TO MAKE ANY CLAIM WITHIN THE SPECIFIED TIME PERIOD WILL RESULT IN THE UNCONDITIONAL WAIVER OF THAT CLAIM. LI-TX reserves the right to accept or reject any claim in whole or in part. LI-TX shall not be responsible for any defects caused by your willful or negligent acts, incorrect storage or installation of the Products, or normal wear and tear. Any claim based on a manufacturer's warranty shall be made within the period prescribed by the warranty.

**10. Credit Report and Payment.** You hereby give LI-TX permission to make all reasonable inquiries into your credit history. Following such reviews, LI-TX will notify you of the payment terms for your orders, which will be one of the following:

- (a) *Net 30 Days.* All amounts for the Products ordered are due within 30 days of date of LI-TX's invoice for the Products.
- (b) *25% Down, Net 30 Days.* You must pay 25% of the order amount upon notice from LI-TX of the terms of payment, and the remaining balance is due within 30 days of date of LI-TX's invoice for the Products.
- (c) *50% Down, Net 30 Days.* You must pay 50% of the order amount upon notice from LI-TX of the terms of payment, and the remaining balance is due within 30 days of date of LI-TX's invoice for the Products.
- (d) *100% Down or Payment Bond.* The full price of all orders must be paid upon notice from LI-TX of the terms of payment. Alternatively, you may provide a payment bond or other security acceptable to LI-TX.

If you are required to make a down payment under the preceding payment terms, LI-TX may not process your order for Products under this contract until such down payment is received by LI-TX. If payment is not made in full by the due date, LI-TX may charge interest at a rate of up to 1 ½% per month (18% per year compounded monthly) on the amount outstanding until its is paid in full. You agree that you will not withhold payment of any amount due because of any other claims or set-off you may have against LI-TX.

**11. Collection and Other Fees.** You agree to pay LI-TX all costs, including reasonable attorneys fees, incurred by LI-TX in collecting amounts you owe to LI-TX or in otherwise enforcing, asserting, or defending these terms and conditions.

**12. Indemnity.** If the Products are to be manufactured or any process is to be applied to the Products in accordance with a specification submitted by you, you hereby indemnify LI-TX against all loss, damages, costs and expenses awarded against or incurred by LI-TX in connection with or paid or agreed to be paid by LI-TX in settlement of any claim whatsoever including, but not limited to, infringement of any patent, copyright, design, trademark or other intellectual property rights of any other person that results from LI-TX's use of your specification.

**13. No Installation.** These terms and conditions do not govern the installation of any Products purchased from LI-TX. Please refer to your installation agreement for the terms relating to installation.

**14. Force Majeure.** LI-TX shall not be responsible for any failure or delay in the performance of any of its obligations due to causes beyond its control, including, without limitation, fire, storm, flood, freeze, accident, customs or other acts of government, labor disputes, failure or delays of energy, wars, acts of terrorism, riots, public disorders and acts of God.

**15. Disputes.** Any disputes relating to these terms and conditions shall be decided in accordance with the laws of the State of Texas without reference to conflicts of laws principles. Exclusive jurisdiction and venue of any lawsuit relating to this contract shall lie in the state and federal courts of Travis County, Texas.

**16. Miscellaneous.** The invalidity or unenforceability of any of these Terms and Conditions shall not affect the validity or enforceability of any other Terms and Conditions. Any delay or failure by LI-TX in enforcing its rights shall not be construed as a waiver of those rights. This Agreement shall inure to the benefit of and be binding upon each of the parties hereto and their respective heirs, executors, administrators, legal personnel, representatives, successors and assigns, but shall not be assignable by you without the written consent of LI-TX. This Agreement constitutes the entire agreement between the parties on the subject matter hereof and supersedes all prior agreements, representations, warranties, statements, promises, arrangements, and understandings, whether written or oral, expressed or implied with respect thereto. Any changes or amendments to these Terms and Conditions must be agreed in writing by both parties.